



2/3 inch MEGAPIXEL Machine Vision Lens



MPW3 Series

- Compact & Lightweight
- Shorter Working Distance
- Nominal Distortion Design
- Ensures Corner Brightness

IMX250
IMX264
2/3" 3.45µm

RJ32S4
S3AA0DK
2/3" 3.45µm

IMX178
1/1.8" 2.4µm

ICX625
2/3" 3.45µm

EV2S05M
1/1.8" 2.8µm

2/3" 2.74µm

8 models available (5, 8, 12, 16, 25, 35, 50, 75mm)

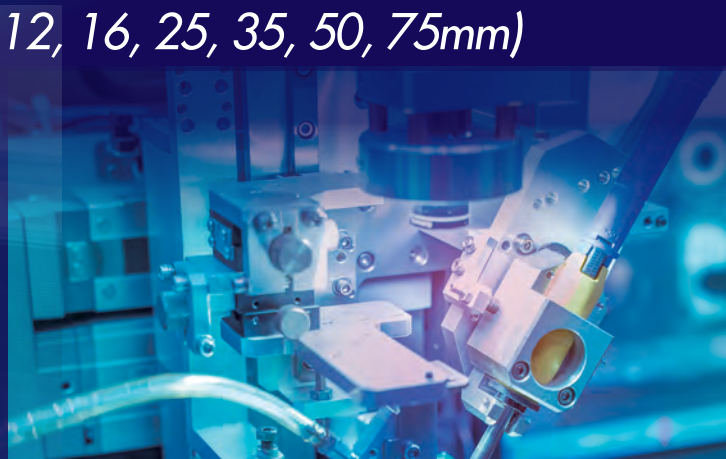

M0528-MPW3				
Model No.	M0528-MPW3	Effective Lens Aperture	Front	φ45.5mm
Focal Length	5mm	Rear	φ9.9mm	
Max. Aperture Ratio	1:2.8	Distortion	2/3type(Y=5.5mm)	0.0%±
Max. Image Format	8.8mm x 6.6mm(φ11mm)		1/1.8type(Y=4.5mm)	-2.1%
Operation Range	Inis F2.8 - 16.0	Back Focal Length	9.2mm	
Focus	0.1m - inf.	Flange Back Length	17.526mm	
Control	Inis Manual	Mount	C-Mount	
Object Dimension at M.O.D.	2/3 Type 570.6 x 427.3 mm	Filter Size	M27 P=0.75mm	
	1/1.8 Type 467.0 x 347.4 mm	Dimensions	φ75mm x 54mm	
	1/3 Type 367.3 x 274.6 mm	Weight	-g	
Angle of View	D 94.6°	1/1.8 type	83.8°	71.4°
	H 83.2°		71.6°	59.8°
	V 67.5°		58.3°	46.6°
Operating Temperature	-10°C - +50°C			

Dimensions

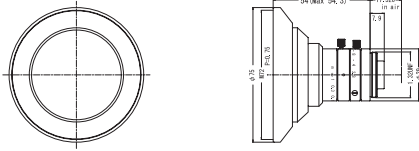

M0828-MPW3				
Model No.	M0828-MPW3	Effective Lens Aperture	Front	φ21.2mm
Focal Length	8mm	Rear	φ10.1mm	
Max. Aperture Ratio	1:2.8	Distortion	2/3type(Y=5.5mm)	-1.8%
Max. Image Format	8.8mm x 6.6mm(φ11mm)		1/1.8type(Y=4.5mm)	-1.7%
Operation Range	Inis F2.8 - 16.0	Back Focal Length	9.2mm	
Focus	0.1m - inf.	Flange Back Length	17.526mm	
Control	Inis Manual	Mount	C-Mount	
Object Dimension at M.O.D.	2/3 Type 122.2 x 90.8 mm	Filter Size	M30.5 P=0.5mm	
	1/1.8 Type 98.2 x 75.8 mm	Dimensions	φ32mm x 35.5mm	
	1/3 Type 65.6 x 49.0 mm	Weight	58g	
Angle of View	D 68.5°	1/1.8 type	57.7°	47.2°
	H 57.0°		47.3°	38.5°
	V 44.2°		37.5°	29.4°
Operating Temperature	-10°C - +50°C			

Dimensions

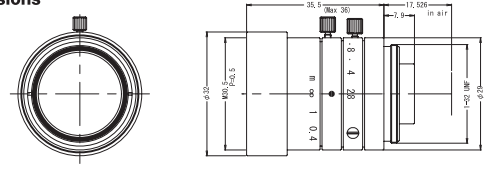

M1228-MPW3				
Model No.	M1228-MPW3	Effective Lens Aperture	Front	φ18.8mm
Focal Length	12mm	Rear	φ10.3mm	
Max. Aperture Ratio	1:2.8	Distortion	2/3type(Y=5.5mm)	-0.1%
Max. Image Format	8.8mm x 6.6mm(φ11mm)		1/1.8type(Y=4.5mm)	0.0%±
Operation Range	Inis F2.8 - 16.0	Back Focal Length	9.2mm	
Focus	0.1m - inf.	Flange Back Length	17.526mm	
Control	Inis Manual	Mount	C-Mount	
Object Dimension at M.O.D.	2/3 Type 83.0 x 62.0 mm	Filter Size	M27 P=0.5mm	
	1/1.8 Type 67.7 x 50.6 mm	Dimensions	φ29mm x 43.5mm	
	1/3 Type 53.4 x 40.2 mm	Weight	60g	
Angle of View	D 49.3°	1/1.8 type	40.8°	33.0°
	H 30.8°		33.1°	26.7°
	V 30.8°		26.0°	20.3°
Operating Temperature	-10°C - +50°C			

Dimensions

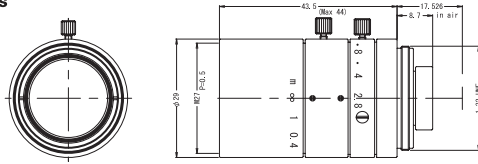

M1628-MPW3				
Model No.	M1628-MPW3	Effective Lens Aperture	Front	φ14.1mm
Focal Length	16mm	Rear	φ9.1mm	
Max. Aperture Ratio	1:2.8	Distortion	2/3type(Y=5.5mm)	0.5%
Max. Image Format	8.8mm x 6.6mm(φ11mm)		1/1.8type(Y=4.5mm)	0.2%
Operation Range	Inis F2.8 - 16.0	Back Focal Length	10.3mm	
Focus	0.25m - inf.	Flange Back Length	17.526mm	
Control	Inis Manual	Mount	C-Mount	
Object Dimension at M.O.D.	2/3 Type 140.5 x 105.4 mm	Filter Size	M27 P=0.5mm	
	1/1.8 Type 115.0 x 86.2 mm	Dimensions	φ29mm x 29mm	
	1/3 Type 91.0 x 68.6 mm	Weight	37g	
Angle of View	D 37.8°	1/1.8 type	31.4°	25.0°
	H 30.7°		25.3°	20.2°
	V 23.3°		19.2°	15.3°
Operating Temperature	-10°C - +50°C			

Dimensions

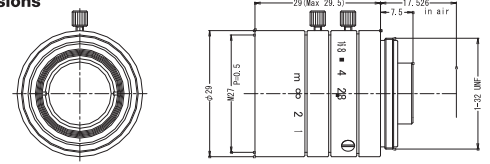

M2528-MPW3				
Model No.	M2528-MPW3	Effective Lens Aperture	Front	φ14.1mm
Focal Length	25mm	Rear	φ10.5mm	
Max. Aperture Ratio	1:2.8	Distortion	2/3type(Y=5.5mm)	0.8%
Max. Image Format	8.8mm x 6.6mm(φ11mm)		1/1.8type(Y=4.5mm)	0.5%
Operation Range	Inis F2.8 - 16.0	Back Focal Length	11.5mm	
Focus	0.2m - inf.	Flange Back Length	17.526mm	
Control	Inis Manual	Mount	C-Mount	
Object Dimension at M.O.D.	2/3 Type 70.7 x 53.0 mm	Filter Size	M27 P=0.5mm	
	1/1.8 Type 57.8 x 43.3 mm	Dimensions	φ29mm x 31.5mm	
	1/3 Type 45.7 x 34.5 mm	Weight	42g	
Angle of View	D 24.6°	1/1.8 type	20.3°	16.1°
	H 19.9°		16.3°	13.0°
	V 15.0°		12.3°	9.8°
Operating Temperature	-10°C - +50°C			

Dimensions

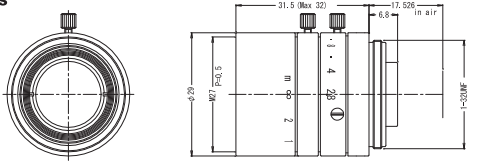

M3528-MPW3				
Model No.	M3528-MPW3	Effective Lens Aperture	Front	φ17.8mm
Focal Length	35mm	Rear	φ11.8mm	
Max. Aperture Ratio	1:2.8	Distortion	2/3type(Y=5.5mm)	0.1%
Max. Image Format	8.8mm x 6.6mm(φ11mm)		1/1.8type(Y=4.5mm)	0.0%±
Operation Range	Inis F2.8 - 16.0	Back Focal Length	18.0mm	
Focus	0.25m - inf.	Flange Back Length	17.526mm	
Control	Inis Manual	Mount	C-Mount	
Object Dimension at M.O.D.	2/3 Type 45.1 x 33.8 mm	Filter Size	M27 P=0.5mm	
	1/1.8 Type 36.6 x 27.4 mm	Dimensions	φ29mm x 38.5mm	
	1/3 Type 28.3 x 21.9 mm	Weight	48g	
Angle of View	D 17.9°	1/1.8 type	14.4°	11.6°
	H 14.3°		11.7°	9.3°
	V 10.8°		8.7°	7.0°
Operating Temperature	-10°C - +50°C			

Dimensions

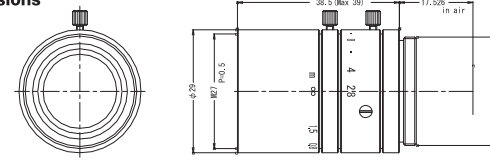

M5028-MPW3				
Model No.	M5028-MPW3	Effective Lens Aperture	Front	φ17.8mm
Focal Length	50mm	Rear	φ9.9mm	
Max. Aperture Ratio	1:2.8	Distortion	2/3type(Y=5.5mm)	0.0%±
Max. Image Format	8.8mm x 6.6mm(φ11mm)		1/1.8type(Y=4.5mm)	0.0%±
Operation Range	Inis F2.8 - 16.0	Back Focal Length	26.8mm	
Focus	0.3m - inf.	Flange Back Length	17.526mm	
Control	Inis Manual	Mount	C-Mount	
Object Dimension at M.O.D.	2/3 Type 64.1 x 48.1 mm	Filter Size	M27 P=0.5mm	
	1/1.8 Type 52.5 x 39.4 mm	Dimensions	φ29mm x 56mm	
	1/3 Type 41.5 x 31.3 mm	Weight	65g	
Angle of View	D 12.5°	1/1.8 type	10.2°	8.1°
	H 10.0°		8.2°	6.5°
	V 7.5°		6.2°	4.9°
Operating Temperature	-10°C - +50°C			

Dimensions

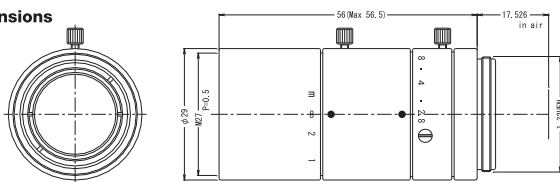

M7528-MPW3				
Model No.	M7528-MPW3	Effective Lens Aperture	Front	φ26.1mm
Focal Length	75mm	Rear	φ15.8mm	
Max. Aperture Ratio	1:2.8	Distortion	2/3type(Y=5.5mm)	0.3%
Max. Image Format	8.8mm x 6.6mm(φ11mm)		1/1.8type(Y=4.5mm)	0.2%
Operation Range	Inis F2.8 - 16.0	Back Focal Length	14.8mm	
Focus	0.4m - inf.	Flange Back Length	17.526mm	
Control	Inis Manual	Mount	C-Mount	
Object Dimension at M.O.D.	2/3 Type 47.0 x 35.2 mm	Filter Size	M34 P=0.5mm	
	1/1.8 Type 38.4 x 28.8 mm	Dimensions	φ36mm x 75mm	
	1/3 Type 30.4 x 22.9 mm	Weight	102g	
Angle of View	D 8.4°	1/1.8 type	6.9°	5.4°
	H 6.7°		5.5°	4.3°
	V 5.0°		4.1°	3.3°
Operating Temperature	-10°C - +50°C			

Dimensions

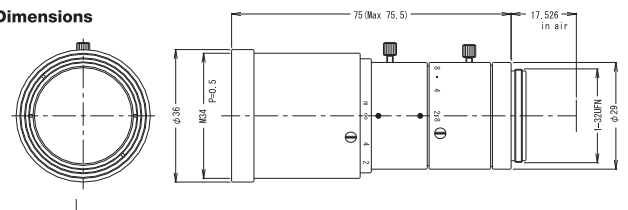

*Described up to one decimal places.

Specification is subject to change without any notice